

ATTENTION
BEFORE BEGINNING THE INSTALLATION OF YOUR NEW GRILL, ENSURE THAT
THE KIT YOU HAVE RECEIVED MATCHES YOUR TRUCK MODEL
PLEASE READ THE INSTRUCTIONS COMPLETELY BEFORE BEGINNING

INSTALLATION INSTRUCTIONS

- 1- ARRANGE THE LOUVER BARS AND SURROUND PIECES ON A FLAT SURFACE. THE PART NUMBERS FOR THE SURROUND ARE ETCHED ON THE PARTS AND SHOULD BE ARRANGED AS FOLLOWS: CL7323023-U03 IS DRIVER AND PASSENGER SIDE, CL7323023-U02 IS THE TOP, CL7323023-U04 IS THE BOTTOM, CL7323023-U07 IS THE LEFT SIDE HOOD DEFLECTOR, CL7323023-U08 IS THE RIGHT SIDE HOOD DEFLECTOR, CL7323023-U09 IS THE GRILL HANDLE, CL7323023-U01 IS THE UPPER LOUVERS STYLE BARS, CL7323023-U05 ARE THE 8 IN BETWEEN LOUVERS STYLE BARS. AND CL7323023-U06 IS THE LOWER LOUVERS STYLE BARS YOU SHOULD ALSO HAVE RECEIVED ONE CL7323023-U10 AND ONE CL7323023-U11.
- 2- REMOVE THE COMPLETE FACTORY GRILL FROM THE HOOD AND THE 4 RUBBER PLUGS IN THE 4 CORNERS.
- 3- REMOVE THE FACTORY BLACK WIRE SCREEN AND THE FREIGHTLINER LOGO THEY WILL BE REINSTALL IN A FURTHER STEP.
- 4- INSERT THE WELLNUTS IN THE 2 RIGHT AND LEFT EMBOSSED SURFACE OF THE GRILL FRAME IN THE LOWER SECTION.
- 5- TAKE THE U04 PART OF THE SURROUND, PEEL THE PVC FILM AROUND ALL HOLES THEN TAKE THE U03 PARTS OF THE SURROUND, PEEL THE PVC FILM ALL OVER AND USING A 1 1/4"LG CARRIAGE BOLTS, 4 NYLON FLAT WASHERS, 1FLAT WASHER AND 1 HEX. NUTS ϕ 1/4 AT BOTH ENDS. IN THE HIGHER HOLES USE A 1"LG HEX. BOLTS AND 1 FLAT WASHERS ϕ 1/4 ON BOTH SIDES, DO NOT TIGHTEN.
- 6- TAKE THE U02 PART OF THE SURROUND, PEEL THE PVC FILM AROUND ALL HOLES, PLACE IT BETWEEN THE U03 AND THE GRILL FRAME THEN TAKE THE U01 PART, PEEL THE PVC FILM AROUND ALL BOLT HOLES. ALINE PARTS HOLES AND INSERT 1 1/4"LG CARRIAGE BOLTS, FLAT WASHERS AND HEX. NUTS ϕ 1/4 AT BOTH ENDS. IN THE LOUVER MIDDLE HOLE USE A 1/2"LG CARRIAGE BOLTS, FLAT WASHERS AND NYLON LOCK NUTS ϕ #10. TIGHTEN BOLTS AND SCREWS FIRMLY.

INSTALLATION INSTRUCTIONS

- 7- TAKE THE U07 AND U08 PARTS, PEEL THE PVC FILM AROUND ALL HOLES. INSTALL THE U07 ON DRIVER SIDE AS FOLLOW, SLIDE IT BEHIND THE U02 PART AND ALINE THE HOLES, USE A 1/2"LG TRUSS PHILLIPS SCREW, A FLAT WASHER AND A NYLON LOCK NUT #10, DO NOT TIGHTEN. USE 2 HEX. WASHER TEK #10 X 3/4"LG (SELF DRILLING) TO SCREW THE BEND SECTION TO THE GRILL FRAME. SAME WAY FOR U08 PASSENGER SIDE, TIGHTEN BOLTS AND SCREWS FIRMLY.
- 8- TAKE THE U05 PART, PEEL THE PVC FILM AROUND ALL BOLT HOLES. INSTALL THE 8 IN BETWEEN LOUVER STYLE BARS, USING 32 (1/2"LG) CARRIAGE BOLTS, 32 FLAT WASHERS AND 32 NYLON LOCK NUTS #10. TIGHTEN BOLTS AND SCREWS FIRMLY.
- 9- TAKE THE U06 PART, PEEL THE PVC FILM COMPLETELY. LOOSEN THE LOWER BOLTS OF U04 & U03 TO INSTALL THE LOWER LOUVER STYLE BAR. TIGHTEN BOLTS AND SCREWS FIRMLY FROM THE INSIDE OF THE HOOD.
- 10- WHILE THE HOOD IS OPEN, INSTALL THE BLACK WIRE SCREEN, TO RETAIN IT IN PLACE USE THE U10 AT THE UPPER POSITION AND THE U11 AT THE LOWER POSITION AS ILLUSTRATED, USING 4 LOCK WASHERS AND 4 HEX. NUTS ϕ 1/4", TIGHTEN BOLTS AND SCREWS FIRMLY.
- 11- REINSTALL THE FREIGHTLINER LOGO USING THE 3 PUSH NUTS.
- 12- TAKE THE PART U09, PEEL THE PVC FILM AROUND ALL HOLES. TEMPORARILY INSTALL THE HANDLE TO THE U02 PART, THEN MARK HANDLE HOLES ON HOOD.

CAUTION
REMOVE THE HANDLE TO PREVENT DAMAGE.

- 13- DRILL HANDLE HOLES AT ϕ 9/32" (.28125"). PEEL PVC COMPLETELY AND REINSTALL IT. TIGHTEN ALL BOLTS AND SCREWS FIRMLY.

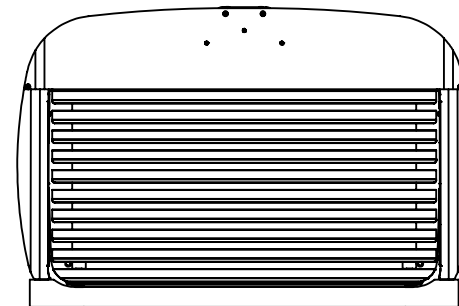

ITEM NO.	PART NO.	DESCRIPTION	QTY
1	M7323023CC	FRONT GRILL	37
2	-	PR7323023-U02	1
3	-	PR7323023-U03	2
4	-	PR7323023-U04	1
5	-	PR7323023-U01	1
6	-	PR7323023-U05	8
7	-	PR7323023-U06	1
8	-	PR7323023-U07	1
9	-	PR7323023-U08	1
10	-	PR7323023-U09	1
11	-	PR7323023-U10	1
12	-	PR7323023-U11	1
13	K7323023BB	HARDWARE KIT INCLUDE:	37
14	-	CARRIAGE BOLT 10-32NFX1/2"SS	33
15	-	HARDWARE KIT INCLUDES:	1
16	-	FENDER WASHER 1/4"OD1 1/4"SS	2
17	-	TRUSS PHILLIPS #10-32NF X 1/2"SS	4
18	-	PUSHNUT 1/4"GRAY	3
19	-	HEX. WASHER BOLT #10 X 3/4	4
20	-	CARRIAGE BOLT 1/4-20 X 1 1/4"LG	4
21	-	FLAT WASHER 1/4" SS	6
22	-	HEX NUT 1/4-20NC	10
23	-	LOCK WASHER 1/4" SS	6
24	-	HEX. BOLT 1/4NC X 1	2
25	-	WELL NUT 1/4NC	2
26	-	NYLON FLAT WASHER 1/4"	8
27	-	HARDWARE KIT INCLUDES:	1
28	-	TRUSS PHILIPS 1/4"-20NCX3/4"SS	2
29	-	BLACK WIRE SCREEN(FROM FACTORY)	-

TRUX ACCESSORIES

TITLE:
FRONT GRILL
FRIEGHTLINER CENTURY CLASS 2005 & UP

SIZE	DWG. NO.		
A	TF-1004		
NAME	DATE	REV	DATE
DRAWN BY P.W.	02-12-2008	PH1	-
SCALE: 1:13		WEIGHT: LBS	SHEET: 1 OF 1

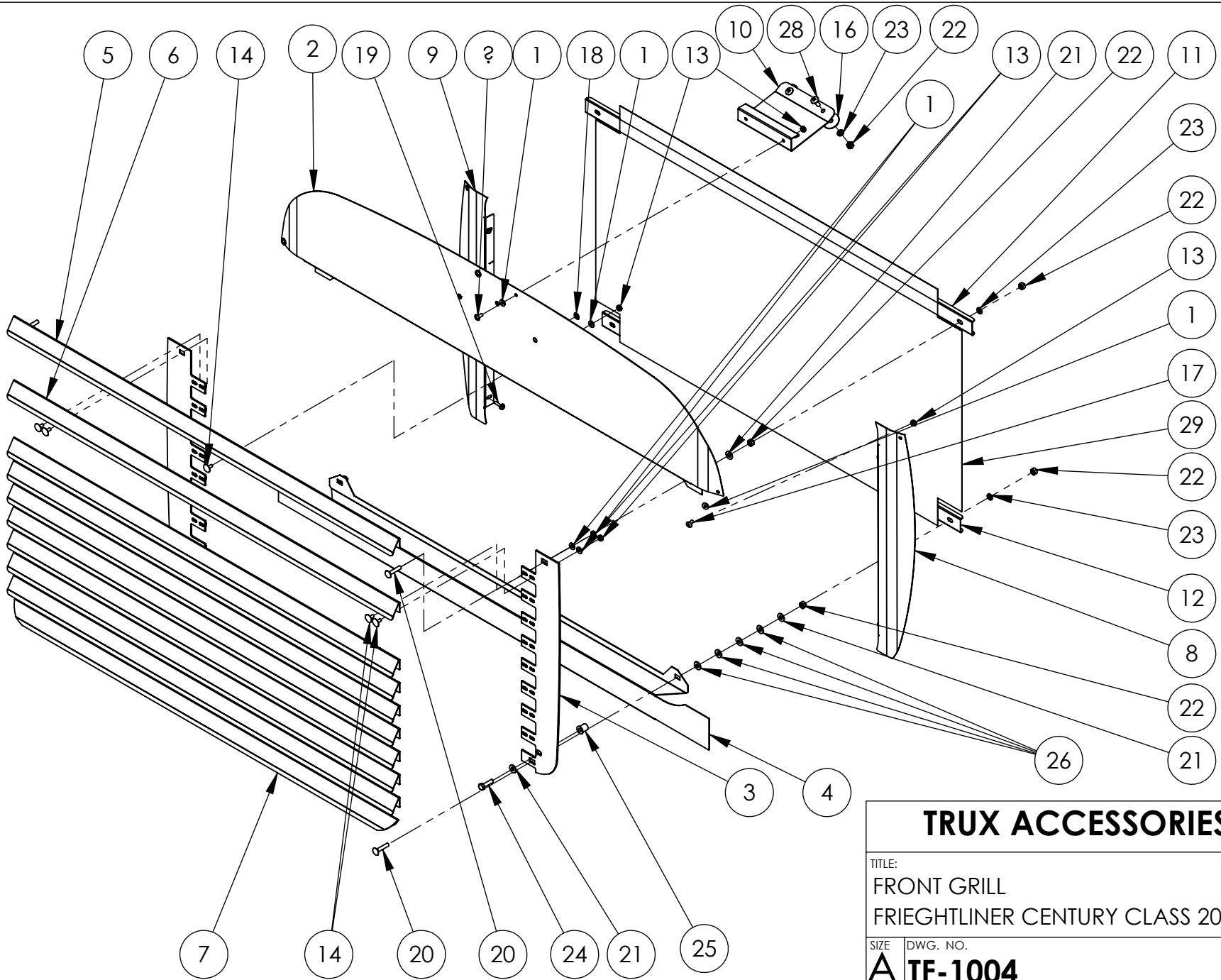

TRUX ACCESSORIES			
TITLE: FRONT GRILL FRIEHTLINER CENTURY CLASS 2005 & UP			
SIZE	DWG. NO.		
A	TF-1004		
NAME	DATE	REV	DATE
DRAWN BY P.W.	02-12-2008	PH1	-
SCALE: 1:10		WEIGHT: LBS	SHEET: 1 OF 1